



Diag. ABA



2/7

T 3/11

Land District: South Auckland  
 Digitally Generated Plan  
 Generated on: 02/05/2024 12:27am Page 8 of 16

Lots 21, 106, 311, 610 - 642, 8038 - 8044 Being a Subdivision of Lot 25 DP 587367

Surveyor: Scott Rodney Carley  
 Firm: Shrimpton and Lipinski Limited Partn

Title Plan  
 LT 600227  
 DRAFT

Diag. ABB



3/7

T 4/11

Land District: South Auckland

Lots 21, 106, 311, 610 - 642, 8038 - 8044 Being a Subdivision of Lot 25 DP 587367

Surveyor: Scott Rodney Carley  
Firm: Shrimpton and Lipinski Limited Partn

Title Plan  
LT 600227  
DRAFT

Digitally Generated Plan  
Generated on: 02/05/2024 12:27am Page 9 of 16

Diag. ABC



21  
19.3800Ha

106  
0.5892Ha  
To Vest as Road In the  
Hamilton City Council

<p>Land District: South Auckland</p> <p>Digitally Generated Plan Generated on: 02/05/2024 12:27am Page 10 of 16</p>	<p>Lots 21, 106, 311, 610 - 642, 8038 - 8044 Being a Subdivision of Lot 25 DP 587367</p>	<p>Surveyor: Scott Rodney Carley Firm: Shrimpton and Lipinski Limited Partn</p>	<p>Title Plan LT 600227 DRAFT</p>
---	--	---	---





Diag. ABE



Land District: South Auckland

Lots 21, 106, 311, 610 - 642, 8038 - 8044 Being a Subdivision of Lot 25 DP 587367

Surveyor: Scott Rodney Carley  
Firm: Shrimpton and Lipinski Limited Partn

Title Plan  
LT 600227  
DRAFT

Digitally Generated Plan  
Generated on: 02/05/2024 12:27am Page 12 of 16

T 7/11



Diag. ABF

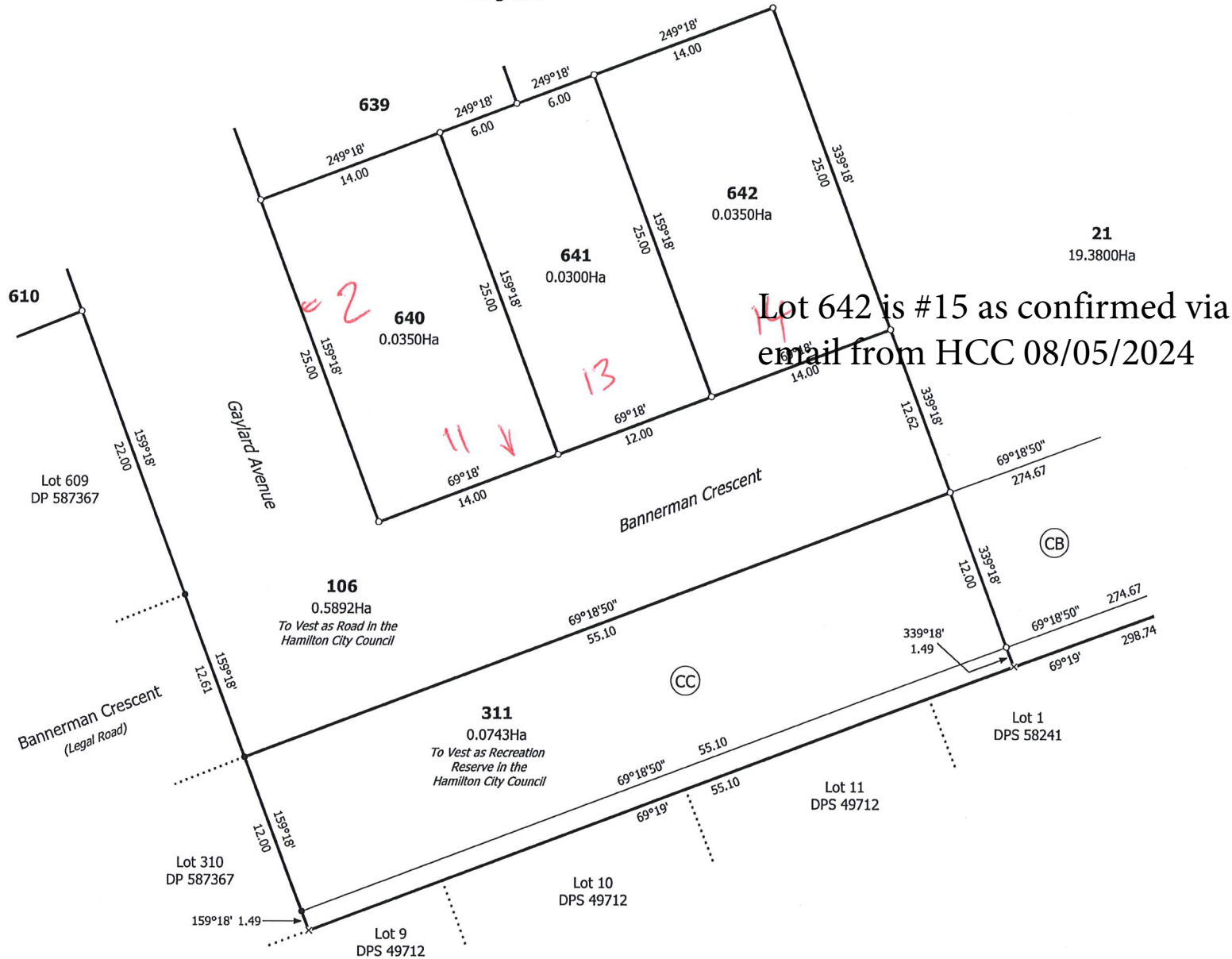

T 8/11

Land District: South Auckland

Lots 21, 106, 311, 610 - 642, 8038 - 8044 Being a Subdivision of Lot 25 DP 587367

Surveyor: Scott Rodney Carley  
Firm: Shrimpton and Lipinski Limited Partn

Title Plan  
LT 600227  
DRAFT

Digitally Generated Plan  
Generated on: 02/05/2024 12:27am Page 13 of 16